

Under Microwave

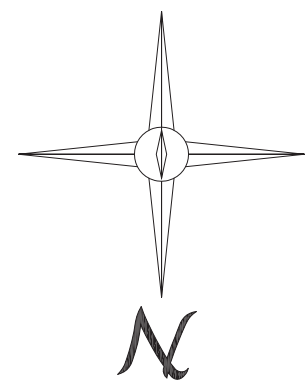
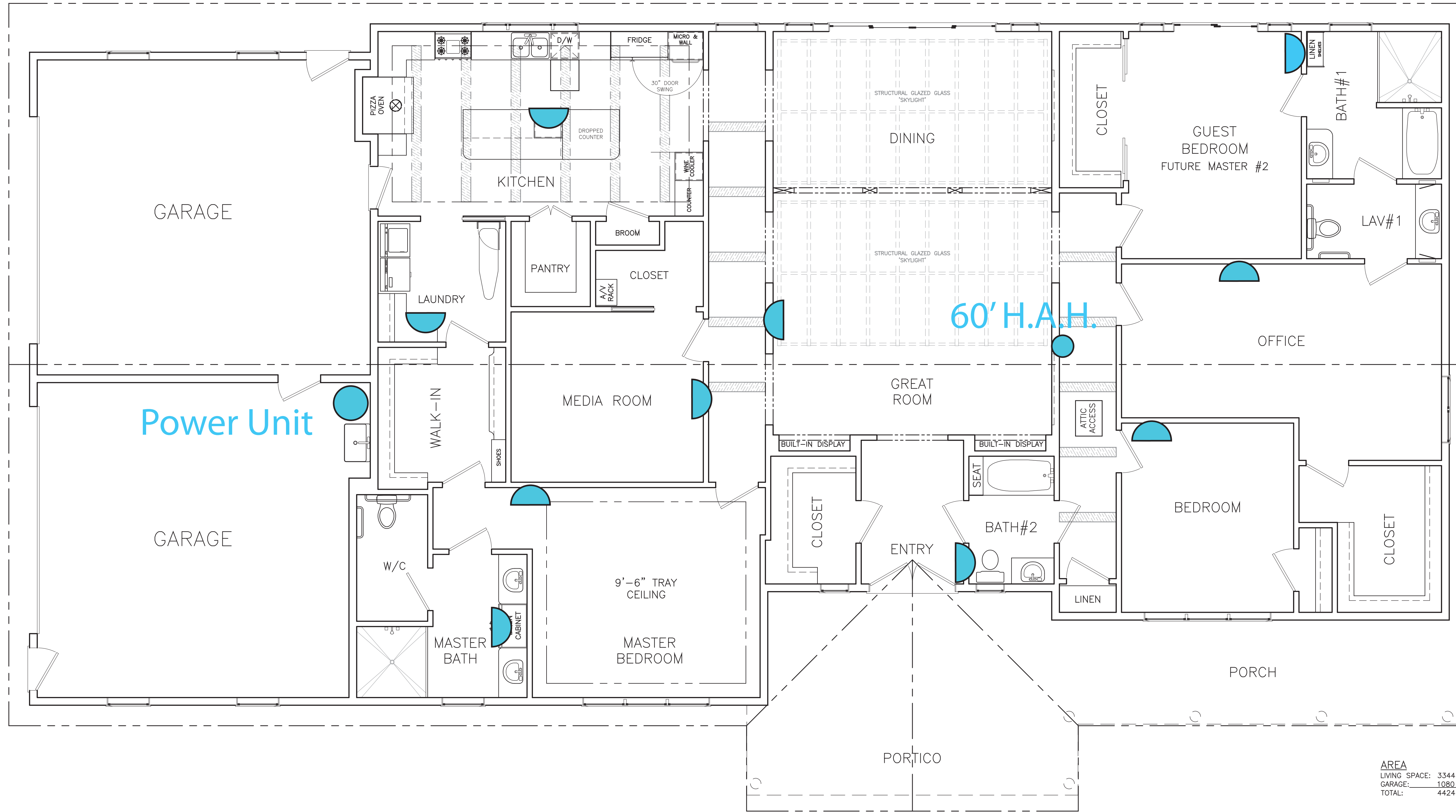

AREA
 LIVING SPACE: 3344 SF.
 GARAGE: 1080 SF.
 TOTAL: 4424 SF.

REVISIONS		
REV	DATE	CHANGE
6.2	09/20/16	SHIFTED MASTER BATH TO HALLWAY 7" SHIFTED MASTER WALK-IN & MEDIA ROOM WALL 6"
6.3	10/01/16	ADDED BUMP-OUT INTO GARAGE SPACE MOVED BROOM CLOSET, ADDED CURVED WALL FEATURE MOVED GARAGE REAR EXTERIOR DOOR 6"
6.4 - 6.6	11/16	KITCHEN MISC LAYOUT & BROOM CLOSET
6.7	11/20/16	TRAY CEILINGS, KITCHEN & MASTER BEDROOM. BROOM CLOSET LOCATION
6.8	12/21/16	MASTER BATH - SWAPPED LOCATION OF LINEN CABINET & VANITY
6.9	03/22/17	MEDIA ROOM - MOVED ENTRY DOOR
6.10	04/18/17	ADDED BEAMS IN HALLWAYS CHGD DOOR SWING - BATH#2 TO HALLWAY ADDED SHEET 9A
7.0	04/20/17	CORRECTED BEAM LOCATIONS IN HALLWAYS (SHEETS 5 & 6) DOCUMENTATION UPDATE, ALL SHEETS TO REVISION 7.0

DRAWN BY: James Rahaim
 DWG. NO. R01600609
 DATE: JUNE 2016

SCALE: 1/4" = 1'
 REVISION: 7.0
 SHEET: 5 OF 9

RESIDENCE PLANS
 John & Mary Ellen Toebees
 218 BYRUM STREET
 CARY, NC.

FIRST FLOOR PLAN